

SECTION A-A
WITH PLYWOOD COVER
AND MACHINE SCREWS

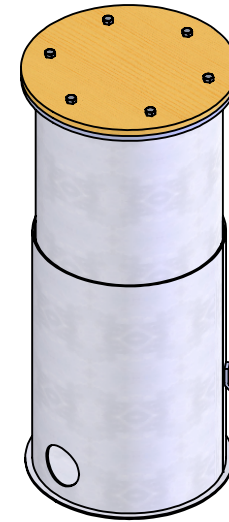

NOTE:

1. LIGHT BASE HEIGHT IS ADJUSTABLE FROM 17 7/8" TO 29 1/2".
2. 2" GROMMET OPENINGS ARE ORIENTED 180° APART. OTHER SIZES AND/OR LOCATIONS MUST BE SPECIFIED WHEN ORDERING.
3. (2) Ø2" GROMMETS (STD) ARE SHIPPED UNASSEMBLED WITH BASE.
4. PLYWOOD COVER IS 1/2" NOMINAL THICKNESS, GRADE CC.
5. A COPPER GROUND LUG IS INCLUDED.
6. CARBON STEEL BASES ARE HOT DIP GALVANIZED PER ASTM A123.
7. L867 ADJUSTABLE LIGHT BASE MUST BE EMBEDDED IN PORTLAND CEMENT CONCRETE TO MEET LOAD REQUIREMENTS OF FAA.
8. AVAILABLE OPTIONS, SPECIFIED WHEN ORDERING, INCLUDE:
 - DRAIN COUPLING
 - STAINLESS STEEL CONSTRUCTION
 - REPLACEABLE STAINLESS STEEL THREADED INSERTS
9. THIS PRODUCT IS CERTIFIED PER FAA ADVISORY CIRCULAR AC150/5345-42 (CURRENT REV).

DWN: DOUG F.	L-867D Ø16" ADJUSTABLE LIGHT BASE, 29 1/2" MAX HEIGHT, W/GROMMETS	 MILLERBERND 622 6TH ST. SO. WINSTED, MN 55395	167ACG295PCC
DATE: 7/17/2017			
SCALE: NTS			
SHEET 1 OF 1			