

**SECTION A-A**  
WITH PLYWOOD COVER  
AND MACHINE SCREWS

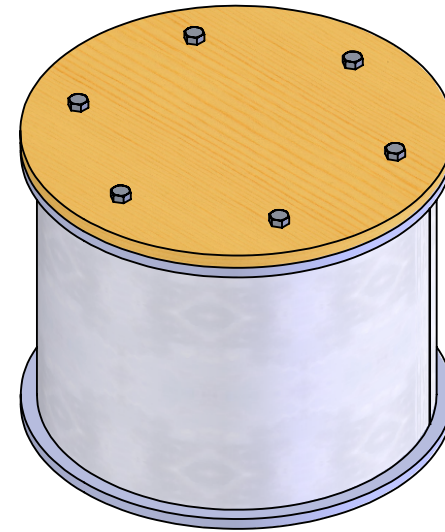

**NOTE:**

1. 'HT'= HEIGHT TO ORDER. MINIMUM HEIGHT IS 1.750'.
2. PLYWOOD COVER FOR L-867 EXTENSION IS 1/2" NOMINAL THICKNESS, GRADE CC.
3. CARBON STEEL EXTENSIONS ARE HOT DIP GALVANIZED PER ASTM A123.
4. AVAILABLE OPTIONS, SPECIFIED WHEN ORDERING, INCLUDE:
  - STAINLESS STEEL CONSTRUCTION
  - REPLACEABLE STAINLESS STEEL THREADED INSERTS
5. THIS PRODUCT IS CERTIFIED PER FAA ADVISORY CIRCULAR AC150/5345-42 (CURRENT REV).

FAA TYPE	NOM DIA	MMC TYPE	'BC'	'CID'	'ID'	'OD'
L-867B	12"	127E	10.250	12.250	9.250	13.500
L-867D	16"	167E	14.250	16.250	12.375	17.375
L-867E	24"	247E	21.500	22.500	20.000	24.000

DWN: DOUG F.	L-867 EXTENSION, Ø12", Ø16" & Ø24"		 <b>MILLERBERND</b>	622 6TH ST. SO. WINSTED, MN 55395	7E
DATE: 7/7/2017					
SCALE: NTS					
SHEET 1 OF 1					